

CRYSTAL IP68 LED MODULE



Features

- Powered by high output 2835 LED (optional brand LEDs).
- High efficiency >150LM/W.
- Constant current.
- Integrated transparent 170° optical lens.
- 50 pcs per string.

Application

- Apply to 6–12 cm depth illuminated letters or light boxes.

Parameters

Items	Parameters	
Part Number	ZE03QD2 (2835)	ZE03QD2 (SEOUL)
CCT (K)	7000K	7000K
Beaming Angle (°)	170°	170°
CRI (Ra)	≥80	≥80
Luminous Flux (lm)	150	100
Voltage (V)	DC24	DC24
Power (W)	1	1
Driving Method	Constant Current (Triode)	Constant Current (INFINEON IC)
Dimension (mm)	74*16.5*10.5	74*16.5*10.5
Working Tem. (°C)	-25 ~ +60	-25 ~ +60
Storage Tem. (°C)	-25 ~ +70	-25 ~ +70
Protection Grade	IP68	IP68

Dimension

Unit: mm/inch

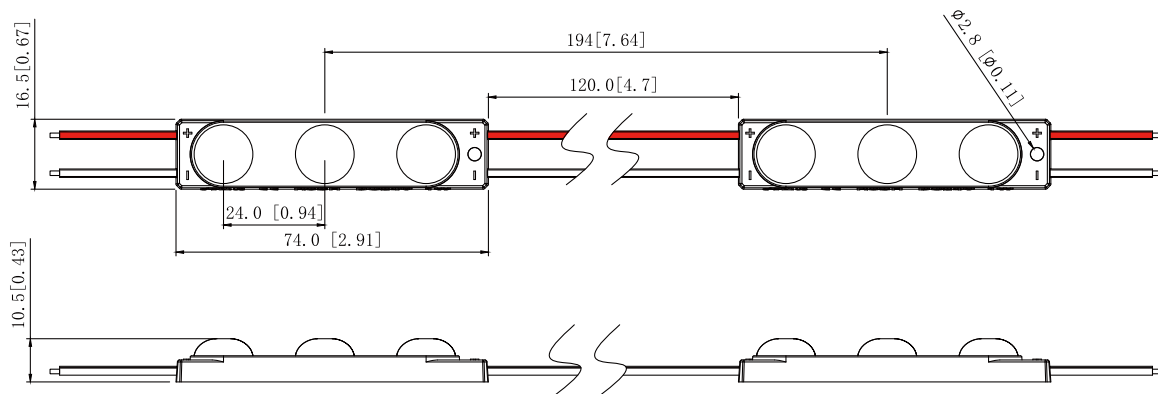

Beaming Angle

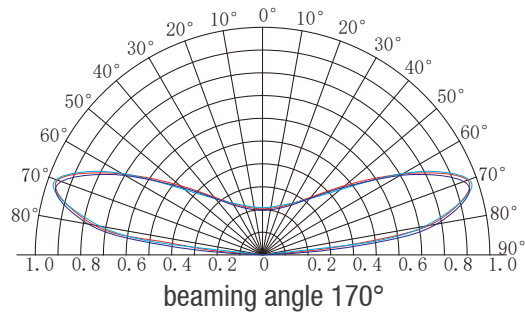

Reference Scheme

Part Number	Depth(mm)	Distance(mm)	Density(pcs/m ²)	Illumination(lux)	Power per unit area(W/m ²)
ZE03QD2(2835)	Dz=40	Dx=100 Dy=90	111	5000	111
	Dz=60	Dx=160 Dy=110	57	2850	57
	Dz=80	Dx=200 Dy=110	46	2150	46
	Dz=100	Dx=200 Dy=110	46	1900	46
	Dz=120	Dx=200 Dy=110	46	1700	46

Remark :

- 01. The transmittance of the Acrylic was 56%.
- 02. The above data is for reference only.

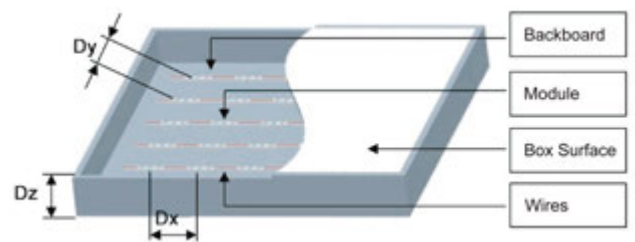

Wire Connection

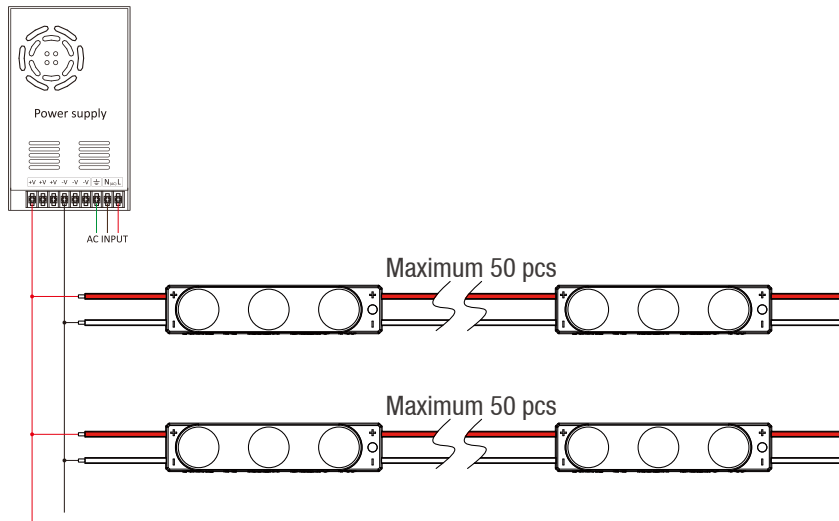

Packing

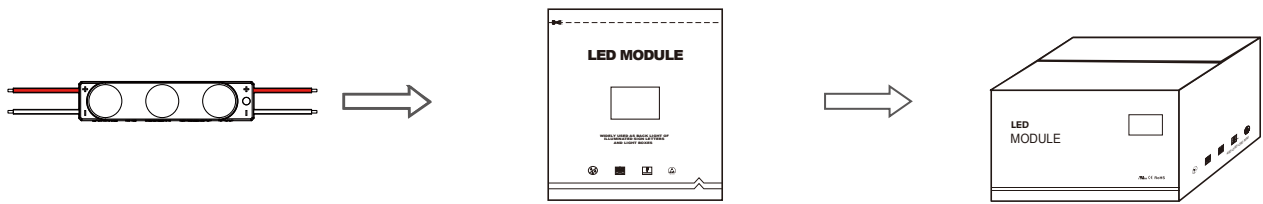

LED Module: 50pcs per string

Wrapped with anti-static bag

Packed in a carton

Packing Specification

- Antistatic bag adopted
- Packing information

Part Number	ZE03QD2
Carton Dimension(mm)	490*450*220
Bag Dimension(mm)	250*460
Bags Per Carton	12
Quantity Per Bag(pcs)	100
Quantity Per Carton(pcs)	1200
Net Weight(kg)	19.10(1±10%)
Gross Weight(kg)	20.10(1±10%)

Due to the packing manner difference, please adhere to the original products in case of discrepancy found between the picture and actual product.

Self-provided tools & material

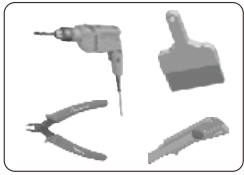

Dust brush, cutter, pencil, wire stripper, and drill

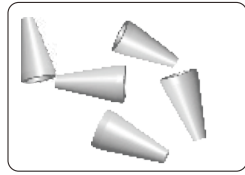

Wire Connector (Standard)

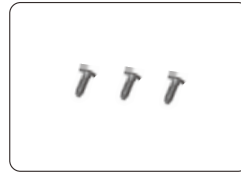

Screw

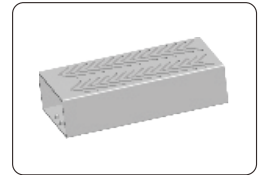

Power Supply

Installation Guidance



- Clean inside the light box.

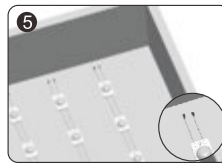

- Strip the end wire for 10mm and cap with the wire connector. Waterproof and anti-corrosion must be done on the connectors.

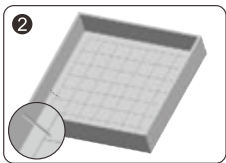

- Determine the appropriate layout.

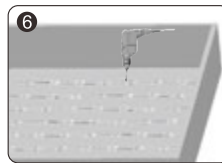

- Locate modules in the optimal position and secure with screws or neutral glass cement, which should be applied at the edge of the modules.

⚠ Note: Avoid breaking the module and wire when fixing with a drill.

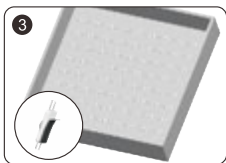

- Peel tape backing and stick modules into place.

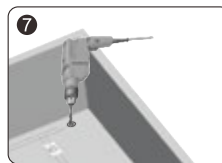

- Drill a hole for connecting power cable. Fixation and protection for the cable must be done on the hole.

⚠ Note: Avoid breaking the light box in drilling the hole.



- Remove the unneeded modules.
- ⚠ Note: Cut in the middle position of the wires between modules.



- Connect to the power cable and make sure that the polarity for connection is correct.

⚠ Note: Red wire is positive and black wire is negative.

Instructions

01. Disassembling or modifying the product is not allowed.
02. Installation with power on is not allowed.
03. Any organic solvent chemical is not allowed.
04. Acidic or alkaline adhesive is not allowed. when install, neutral glass cement could be used for installation purpose, make it drying in open environment for four hours.
05. Isolation and corrosion prevention on all wiring points and wire ends.
06. Make sure the power wire is thick enough and ensure the voltage and connections are connected correctly before power on.
07. This product should be used in a sign, do not expose it in opening site.
08. Installation, maintaining should be done by professional staff.
09. 50 pcs in a serial connection maximum.
10. The power wire between power supply and module should be less than two meters to keep the same brightness on all parts.
11. Initial location with 3M tape, then secure with screws.

Declaration

01. Warranty: 3 years.
02. In order to ensure the safety, the broken wires need to be replaced by the manufacturer or the service agent, or by the staff with the similar qualification.
03. The given data in the specification was based on the laboratory testing, there may be discrepancy found in the actual products.
04. The given drawings in the specification are only for reference, there may be discrepancy found in the actual products.
05. The products are subject to change without prior notification.



SHENZHEN LINGBENYANG IND. CO., LTD.

Tel: +86-755-83544570 E-mail: info@lbyled.com Http://: www.lbyled.com
Company Address.: 28F, Luban Building, Hongli West Road, Futian District, Shenzhen 518034, China
Factory Address: 3F, 4F and 6F, Buiding A&B Xinyongfeng Industrial Area, Yingrenshi Village,
Shiyan Town, Bao'an District, Shenzhen 518108, China